

Mm[®] SL-301 Series



SL-301



SL-301

Specifications:

8(2)A 250VAC T85



6.5A 13A T125
7.5A 15A T125
250VAC 125VAC
250VAC 125VAC

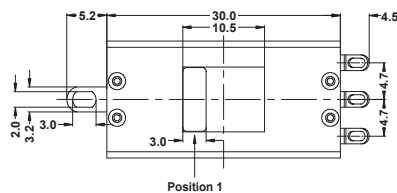

Position 1

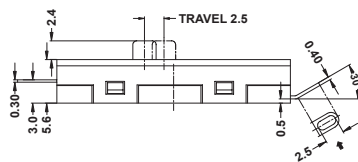
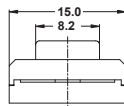

CIRCUIT DIAGRAM

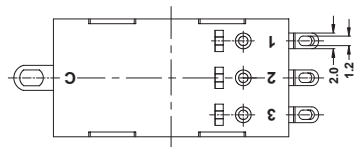
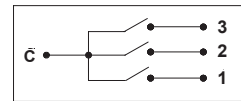

SL-301

001

M

1

S

Circuit
001
002
003
004
005
006
007
008
009
More

Current
M 8(2)A 250VAC
13A 125VAC
L 8(2)A 250VAC
15A 125VAC

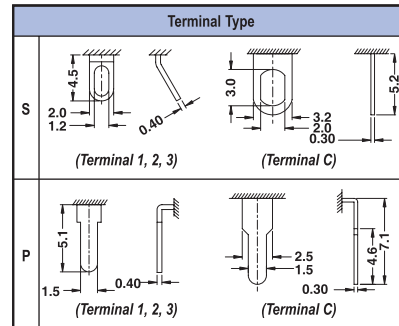
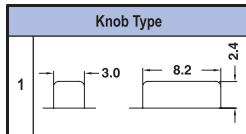

Internal Use Only

SLIDE SWITCH

Circuit Options:

* CIRCUIT.001	CIRCUIT.002	* CIRCUIT.003	CIRCUIT.004	* CIRCUIT.005	* CIRCUIT.006	* CIRCUIT.007																																																																						
<table border="1"> <tr><th>POSITION</th><th>ELECTRIC CIRCUIT</th></tr> <tr><td>1</td><td>C-1 C-2 C-3</td></tr> <tr><td>2</td><td>•</td></tr> <tr><td>3</td><td>•</td></tr> <tr><td>4</td><td>•</td></tr> </table>	POSITION	ELECTRIC CIRCUIT	1	C-1 C-2 C-3	2	•	3	•	4	•	<table border="1"> <tr><th>POSITION</th><th>ELECTRIC CIRCUIT</th></tr> <tr><td>1</td><td>C-1 C-2 C-3</td></tr> <tr><td>2</td><td>•</td></tr> <tr><td>3</td><td>•</td></tr> <tr><td>4</td><td>•</td></tr> </table>	POSITION	ELECTRIC CIRCUIT	1	C-1 C-2 C-3	2	•	3	•	4	•	<table border="1"> <tr><th>POSITION</th><th>ELECTRIC CIRCUIT</th></tr> <tr><td>1</td><td>C-1 C-2 C-3</td></tr> <tr><td>2</td><td>•</td></tr> <tr><td>3</td><td>•</td></tr> <tr><td>4</td><td>•</td></tr> </table>	POSITION	ELECTRIC CIRCUIT	1	C-1 C-2 C-3	2	•	3	•	4	•	<table border="1"> <tr><th>POSITION</th><th>ELECTRIC CIRCUIT</th></tr> <tr><td>1</td><td>C-1 C-2 C-3</td></tr> <tr><td>2</td><td>•</td></tr> <tr><td>3</td><td>•</td></tr> <tr><td>4</td><td>•</td></tr> </table>	POSITION	ELECTRIC CIRCUIT	1	C-1 C-2 C-3	2	•	3	•	4	•	<table border="1"> <tr><th>POSITION</th><th>ELECTRIC CIRCUIT</th></tr> <tr><td>1</td><td>C-1 C-2 C-3</td></tr> <tr><td>2</td><td>•</td></tr> <tr><td>3</td><td>•</td></tr> <tr><td>4</td><td>•</td></tr> </table>	POSITION	ELECTRIC CIRCUIT	1	C-1 C-2 C-3	2	•	3	•	4	•	<table border="1"> <tr><th>POSITION</th><th>ELECTRIC CIRCUIT</th></tr> <tr><td>1</td><td>C-1 C-2 C-3</td></tr> <tr><td>2</td><td>•</td></tr> <tr><td>3</td><td>•</td></tr> <tr><td>4</td><td>•</td></tr> </table>	POSITION	ELECTRIC CIRCUIT	1	C-1 C-2 C-3	2	•	3	•	4	•	<table border="1"> <tr><th>POSITION</th><th>ELECTRIC CIRCUIT</th></tr> <tr><td>1</td><td>C-1 C-2 C-3</td></tr> <tr><td>2</td><td>•</td></tr> <tr><td>3</td><td>•</td></tr> <tr><td>4</td><td>•</td></tr> </table>	POSITION	ELECTRIC CIRCUIT	1	C-1 C-2 C-3	2	•	3	•	4	•
POSITION	ELECTRIC CIRCUIT																																																																											
1	C-1 C-2 C-3																																																																											
2	•																																																																											
3	•																																																																											
4	•																																																																											
POSITION	ELECTRIC CIRCUIT																																																																											
1	C-1 C-2 C-3																																																																											
2	•																																																																											
3	•																																																																											
4	•																																																																											
POSITION	ELECTRIC CIRCUIT																																																																											
1	C-1 C-2 C-3																																																																											
2	•																																																																											
3	•																																																																											
4	•																																																																											
POSITION	ELECTRIC CIRCUIT																																																																											
1	C-1 C-2 C-3																																																																											
2	•																																																																											
3	•																																																																											
4	•																																																																											
POSITION	ELECTRIC CIRCUIT																																																																											
1	C-1 C-2 C-3																																																																											
2	•																																																																											
3	•																																																																											
4	•																																																																											
POSITION	ELECTRIC CIRCUIT																																																																											
1	C-1 C-2 C-3																																																																											
2	•																																																																											
3	•																																																																											
4	•																																																																											
POSITION	ELECTRIC CIRCUIT																																																																											
1	C-1 C-2 C-3																																																																											
2	•																																																																											
3	•																																																																											
4	•																																																																											
<table border="1"> <tr><th>POSITION</th><th>ELECTRIC CIRCUIT</th></tr> <tr><td>1</td><td>C-1 C-2 C-3</td></tr> <tr><td>2</td><td>•</td></tr> <tr><td>3</td><td>•</td></tr> <tr><td>4</td><td>•</td></tr> </table>	POSITION	ELECTRIC CIRCUIT	1	C-1 C-2 C-3	2	•	3	•	4	•	<table border="1"> <tr><th>POSITION</th><th>ELECTRIC CIRCUIT</th></tr> <tr><td>1</td><td>C-1 C-2 C-3</td></tr> <tr><td>2</td><td>•</td></tr> <tr><td>3</td><td>•</td></tr> <tr><td>4</td><td>•</td></tr> </table>	POSITION	ELECTRIC CIRCUIT	1	C-1 C-2 C-3	2	•	3	•	4	•	<table border="1"> <tr><th>POSITION</th><th>ELECTRIC CIRCUIT</th></tr> <tr><td>1</td><td>C-1 C-2 C-3</td></tr> <tr><td>2</td><td>•</td></tr> <tr><td>3</td><td>•</td></tr> <tr><td>4</td><td>•</td></tr> </table>	POSITION	ELECTRIC CIRCUIT	1	C-1 C-2 C-3	2	•	3	•	4	•	<table border="1"> <tr><th>POSITION</th><th>ELECTRIC CIRCUIT</th></tr> <tr><td>1</td><td>C-1 C-2 C-3</td></tr> <tr><td>2</td><td>•</td></tr> <tr><td>3</td><td>•</td></tr> <tr><td>4</td><td>•</td></tr> </table>	POSITION	ELECTRIC CIRCUIT	1	C-1 C-2 C-3	2	•	3	•	4	•	<table border="1"> <tr><th>POSITION</th><th>ELECTRIC CIRCUIT</th></tr> <tr><td>1</td><td>C-1 C-2 C-3</td></tr> <tr><td>2</td><td>•</td></tr> <tr><td>3</td><td>•</td></tr> <tr><td>4</td><td>•</td></tr> </table>	POSITION	ELECTRIC CIRCUIT	1	C-1 C-2 C-3	2	•	3	•	4	•	<table border="1"> <tr><th>POSITION</th><th>ELECTRIC CIRCUIT</th></tr> <tr><td>1</td><td>C-1 C-2 C-3</td></tr> <tr><td>2</td><td>•</td></tr> <tr><td>3</td><td>•</td></tr> <tr><td>4</td><td>•</td></tr> </table>	POSITION	ELECTRIC CIRCUIT	1	C-1 C-2 C-3	2	•	3	•	4	•	<table border="1"> <tr><th>POSITION</th><th>ELECTRIC CIRCUIT</th></tr> <tr><td>1</td><td>C-1 C-2 C-3</td></tr> <tr><td>2</td><td>•</td></tr> <tr><td>3</td><td>•</td></tr> <tr><td>4</td><td>•</td></tr> </table>	POSITION	ELECTRIC CIRCUIT	1	C-1 C-2 C-3	2	•	3	•	4	•
POSITION	ELECTRIC CIRCUIT																																																																											
1	C-1 C-2 C-3																																																																											
2	•																																																																											
3	•																																																																											
4	•																																																																											
POSITION	ELECTRIC CIRCUIT																																																																											
1	C-1 C-2 C-3																																																																											
2	•																																																																											
3	•																																																																											
4	•																																																																											
POSITION	ELECTRIC CIRCUIT																																																																											
1	C-1 C-2 C-3																																																																											
2	•																																																																											
3	•																																																																											
4	•																																																																											
POSITION	ELECTRIC CIRCUIT																																																																											
1	C-1 C-2 C-3																																																																											
2	•																																																																											
3	•																																																																											
4	•																																																																											
POSITION	ELECTRIC CIRCUIT																																																																											
1	C-1 C-2 C-3																																																																											
2	•																																																																											
3	•																																																																											
4	•																																																																											
POSITION	ELECTRIC CIRCUIT																																																																											
1	C-1 C-2 C-3																																																																											
2	•																																																																											
3	•																																																																											
4	•																																																																											
POSITION	ELECTRIC CIRCUIT																																																																											
1	C-1 C-2 C-3																																																																											
2	•																																																																											
3	•																																																																											
4	•																																																																											
<table border="1"> <tr><th>POSITION</th><th>ELECTRIC CIRCUIT</th></tr> <tr><td>1</td><td>C-1 C-2 C-3</td></tr> <tr><td>2</td><td>•</td></tr> <tr><td>3</td><td>•</td></tr> <tr><td>4</td><td>•</td></tr> </table>	POSITION	ELECTRIC CIRCUIT	1	C-1 C-2 C-3	2	•	3	•	4	•	<table border="1"> <tr><th>POSITION</th><th>ELECTRIC CIRCUIT</th></tr> <tr><td>1</td><td>C-1 C-2 C-3</td></tr> <tr><td>2</td><td>•</td></tr> <tr><td>3</td><td>•</td></tr> <tr><td>4</td><td>•</td></tr> </table>	POSITION	ELECTRIC CIRCUIT	1	C-1 C-2 C-3	2	•	3	•	4	•	<table border="1"> <tr><th>POSITION</th><th>ELECTRIC CIRCUIT</th></tr> <tr><td>1</td><td>C-1 C-2 C-3</td></tr> <tr><td>2</td><td>•</td></tr> <tr><td>3</td><td>•</td></tr> <tr><td>4</td><td>•</td></tr> </table>	POSITION	ELECTRIC CIRCUIT	1	C-1 C-2 C-3	2	•	3	•	4	•	<table border="1"> <tr><th>POSITION</th><th>ELECTRIC CIRCUIT</th></tr> <tr><td>1</td><td>C-1 C-2 C-3</td></tr> <tr><td>2</td><td>•</td></tr> <tr><td>3</td><td>•</td></tr> <tr><td>4</td><td>•</td></tr> </table>	POSITION	ELECTRIC CIRCUIT	1	C-1 C-2 C-3	2	•	3	•	4	•	<table border="1"> <tr><th>POSITION</th><th>ELECTRIC CIRCUIT</th></tr> <tr><td>1</td><td>C-1 C-2 C-3</td></tr> <tr><td>2</td><td>•</td></tr> <tr><td>3</td><td>•</td></tr> <tr><td>4</td><td>•</td></tr> </table>	POSITION	ELECTRIC CIRCUIT	1	C-1 C-2 C-3	2	•	3	•	4	•	<table border="1"> <tr><th>POSITION</th><th>ELECTRIC CIRCUIT</th></tr> <tr><td>1</td><td>C-1 C-2 C-3</td></tr> <tr><td>2</td><td>•</td></tr> <tr><td>3</td><td>•</td></tr> <tr><td>4</td><td>•</td></tr> </table>	POSITION	ELECTRIC CIRCUIT	1	C-1 C-2 C-3	2	•	3	•	4	•	<table border="1"> <tr><th>POSITION</th><th>ELECTRIC CIRCUIT</th></tr> <tr><td>1</td><td>C-1 C-2 C-3</td></tr> <tr><td>2</td><td>•</td></tr> <tr><td>3</td><td>•</td></tr> <tr><td>4</td><td>•</td></tr> </table>	POSITION	ELECTRIC CIRCUIT	1	C-1 C-2 C-3	2	•	3	•	4	•
POSITION	ELECTRIC CIRCUIT																																																																											
1	C-1 C-2 C-3																																																																											
2	•																																																																											
3	•																																																																											
4	•																																																																											
POSITION	ELECTRIC CIRCUIT																																																																											
1	C-1 C-2 C-3																																																																											
2	•																																																																											
3	•																																																																											
4	•																																																																											
POSITION	ELECTRIC CIRCUIT																																																																											
1	C-1 C-2 C-3																																																																											
2	•																																																																											
3	•																																																																											
4	•																																																																											
POSITION	ELECTRIC CIRCUIT																																																																											
1	C-1 C-2 C-3																																																																											
2	•																																																																											
3	•																																																																											
4	•																																																																											
POSITION	ELECTRIC CIRCUIT																																																																											
1	C-1 C-2 C-3																																																																											
2	•																																																																											
3	•																																																																											
4	•																																																																											
POSITION	ELECTRIC CIRCUIT																																																																											
1	C-1 C-2 C-3																																																																											
2	•																																																																											
3	•																																																																											
4	•																																																																											
POSITION	ELECTRIC CIRCUIT																																																																											
1	C-1 C-2 C-3																																																																											
2	•																																																																											
3	•																																																																											
4	•																																																																											

*With production mould For more circuit options, please call factory.